

in memory of endless runs . for the next generation

The Ski Museum Liechtenstein transforms architecture into movement: a choreographed sequence of ramps, elevations, narrow corridors and sudden openings guides visitors downward like the flow of an actual descent. Moving between restored lift towers, they experience the sensations that define skiing – the rush of speed, the weightless freedom, the profound silence that blankets the mountains. The building becomes a landscape, the path becomes a slope, and the visitor becomes the skier.

Here, we do not simply display skis as objects of history – we reveal the soul, the culture, and the timeless rhythm of skiing itself.

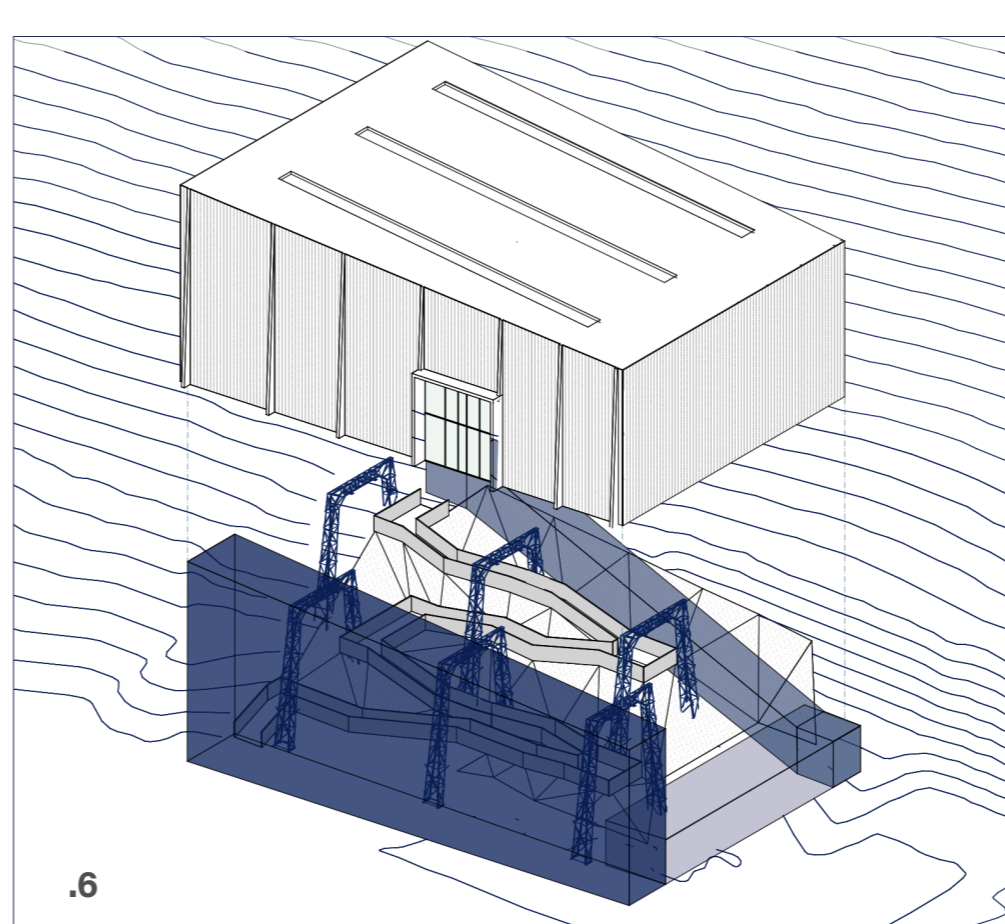
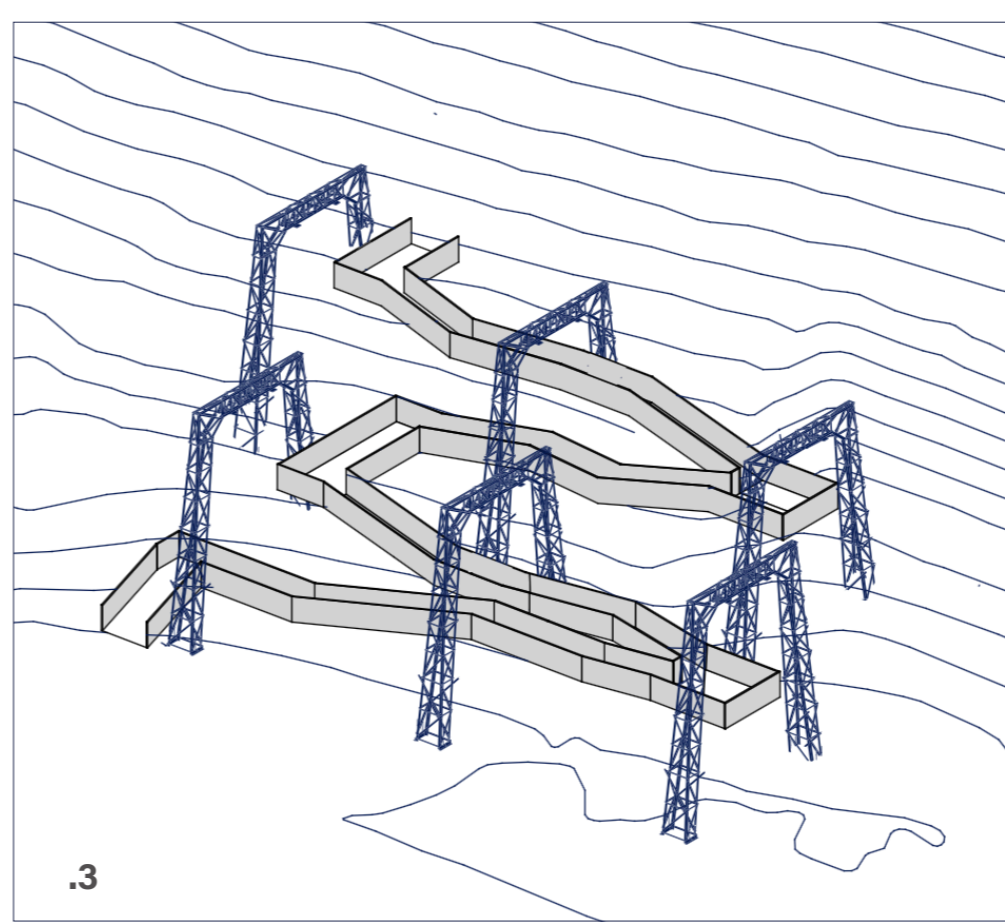
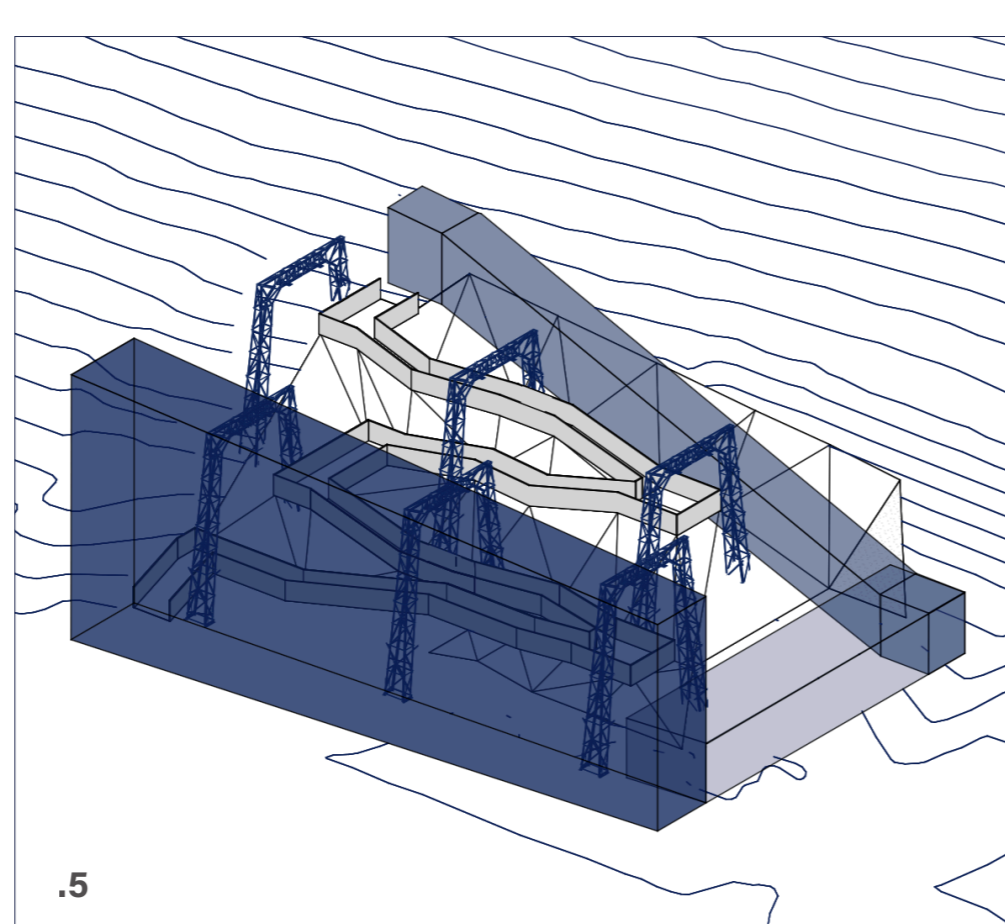
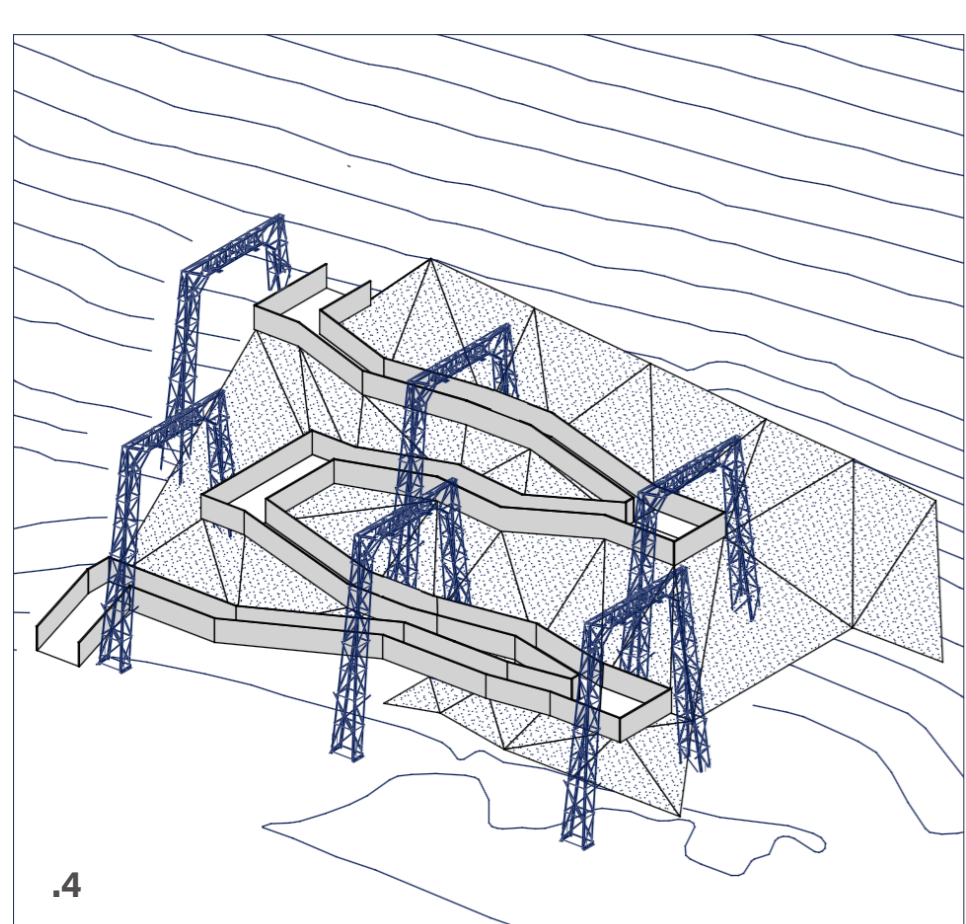
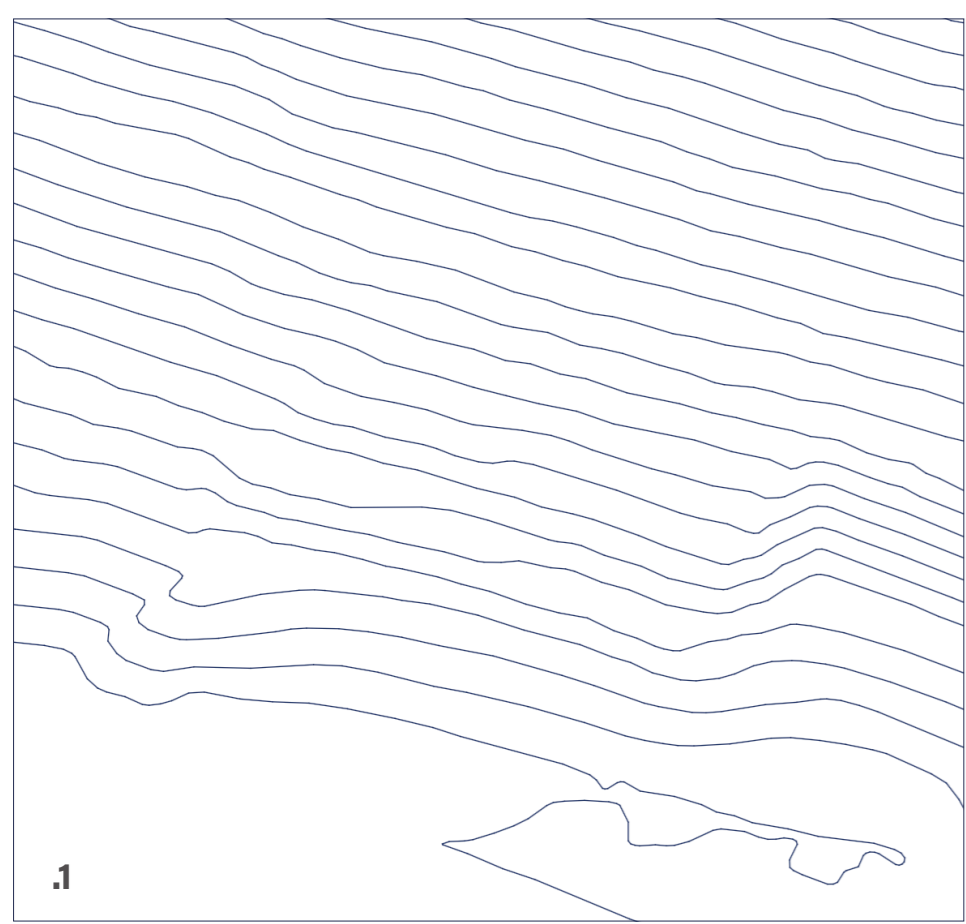

- | | | |
|----|------------------|--------------------|
| .1 | existing terrain | mountain |
| .2 | heritage | ski lift masts |
| .3 | ramps | ski turns |
| .4 | exhibition | mountain |
| .5 | infrastructure | ski lift+apres ski |
| .6 | walls | mountain range |